

Capsule *X*

User guide

You'll be up and running in no time.

Safety Information

Please keep this user guide for reference and share it with anyone who uses your Capsule X. Failure to adhere to this user guide can lead to personal injury or damage to your Capsule X. Halo accept no liability for damaged caused as a result of failing to adhere to this user guide.

General intended use

- Capsule X is intended exclusively for domestic dry vacuuming.
- Store and charge indoors in a dry, cool place out of reach of children.
- Keep the area you are cleaning well lit.
- Do not vacuum wet surfaces or attempt to pick up liquids.
- Do not vacuum where there may be harmful fluids (e.g. chlorine, bleach, drain cleaner).
- Do not vacuum hot coals, cigarette butts, matches or any items that are burning or smoking.
- Do not vacuum hard or sharp objects such as glass, nails, screws, coins etc.
- Do not use on tarmacadam, uneven flooring or other rough surfaces. Uneven stone floors can damage the Power Brush Head and result in damaged carpets.
- Do not use the Power Brush Head if the underside is visibly gouged or damaged.
- Capsule X has a highly powered brush head. Never leave the Power Brush Head in one spot for an extended period of time as this may damage the floor surface.
- Switch off the Power Brush Head on delicate surfaces.
- Capsule's high performance may damage delicate surfaces or upholstery. Test on an inconspicuous area first in Eco mode with the Power Brush Head off. Take care on loose-weave fabrics or where there are loose threads.

Personal safety

- Capsule X can be used by children aged 12 years and above and persons with reduced physical, sensory or mental capabilities or lack of experience and knowledge provided they have been given supervision or instruction concerning the use of Capsule X in a safe way and understand the risks involved. Children shall not play with the appliance. Cleaning and user maintenance shall not be made by children without supervision.
- Take extra care when using Capsule X on the stairs. Always clean upwards from bottom to top.
- Keep Capsule X away from hot surfaces and elevated ambient temperatures.
- Keep fingers, hair and loose clothing away from moving parts and openings when using Capsule X.
- Do not use Capsule X if there is visible damage to the appliance or charger, or if Capsule X or the charger have been left outdoors or immersed in water.
- Capsule X does not stay upright. Between uses, lie flat on the floor in a suitable location so it cannot be stepped on or tripped over. Alternatively Capsule X can be placed in its Wall Dock.

Electrical safety

- Only use Capsule X chargers and spare parts supplied by Halo.
- Never modify the charger in any way.
- The charger has been designed for a specific voltage. Always check that the domestic mains voltage is the same as that stated on the charge rating plate.
- A charger that is matched to one battery pack may cause overheating and risk of fire when used with another battery pack. Always use the approved Capsule X charger.
- Before charging always check the charger and cable. Do not use if there are signs of damage or tangling. If there are signs of damage or tangling seek a genuine replacement charger from Halo.
- Never carry the charger by the cord.
- Do not wrap the cord around the charger.
- Do not pull the cord to remove the charger from the socket or from Capsule X.
- Do not store or charge Capsule X outdoors.
- Always remove the charger when cleaning, emptying or maintaining Capsule X.
- Ensure Capsule X is switched off before connecting or disconnecting any accessories or the Motor Brush Head.

Battery safety

- Capsule X includes Li-Ion batteries; do not incinerate batteries or expose to high temperatures as they may explode.
- Leaks from the battery can occur under extreme conditions. Do not touch any liquid leaks. If liquid gets on the skin wash immediately with plentiful soap and water. If liquid gets in eyes flush them immediately with clean water for a minimum of 10 minutes and seek medical attention. Wear gloves to handle the battery and dispose of immediately in accordance with local regulations.
- In an emergency situation contact professional help immediately!
- Shorting charging terminals may cause burns or fire.
- When you dispose of Capsule X or its battery please do so safely and in accordance with local regulations.
- Keep all openings clear and free from debris as this may impact airflow or suction.
- **WARNING:** For the purpose of recharging the battery only use the detachable power supply unit provided with this appliance

Welcome to Capsule^X

Thank you for choosing your Halo Capsule X cordless vacuum cleaner. We hope you will have many years of use from your Capsule X. Before you begin please read this user guide completely.



About Halo

After 20 years developing vacuum cleaners for big brands, in 2019 Paul Bagwell Founded Halo to take cordless vacuums in a different and better direction.

Innovation for the big household names seemed entirely Focused on miniaturising old technology; but this was compromising performance, weight and efficiency. People were having to carry around heavy machines with very little capacity - the opposite of what they needed. Paul knew there was a better way of using cordless technology to deliver cordless cleaning without compromise.

Capsule cracks the mould. Capsule is lighter and hungrier.

Since launching in 2019 Halo Capsule has won numerous awards and accolades and been recognised as a game-changer. Now with Capsule X, Halo are raising the bar even higher: with extra power, extra capacity and the same amazing low weight.

Halo design and develop our unique and award-winning vacuums at our base in Leamington Spa, Warwickshire, England.



Best of British
Design

Patents Granted and Pending

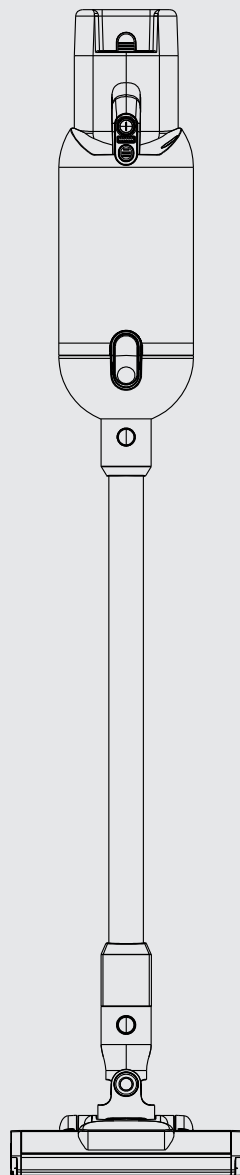

What's in the box

- 1 Capsule X Main Unit
- 2 Motor Brush Head
- 3 Crevice Tool
- 4 Brush and upholstery tool
- 5 Extension Tube
- 6 Charger
- 7 Dust Pouches
- 8 Accessory Clip
- 9 32V Battery

Optional Accessories:

- A Wall Dock
- B Hard Floor Roller
- C Stretch Hose
- D Mini Power Brush

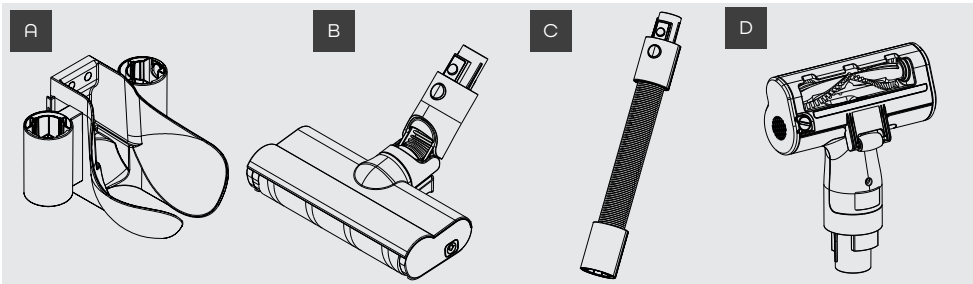
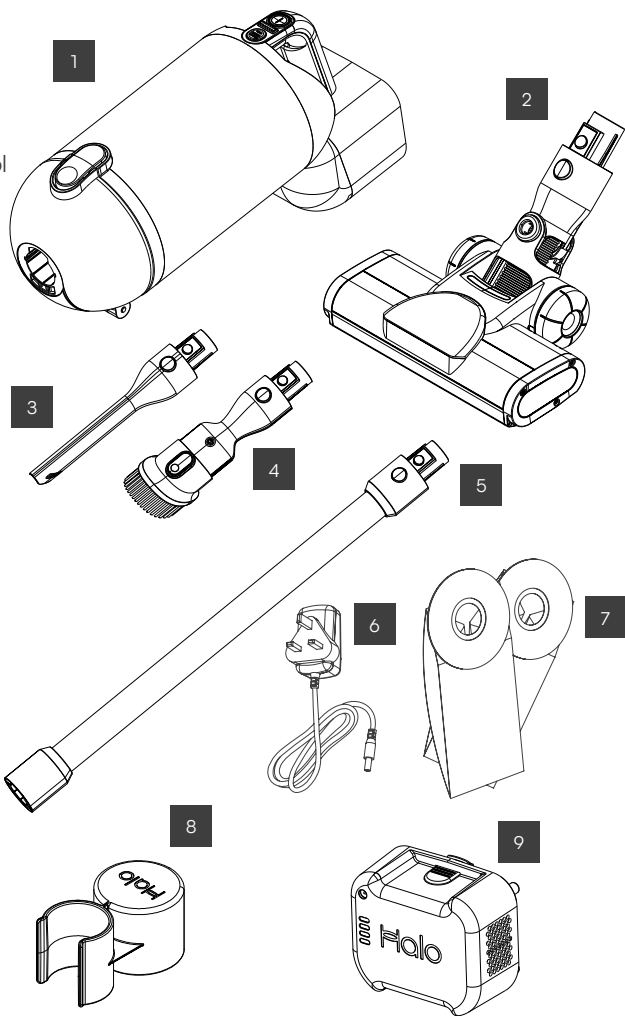

Getting started

Fitting the Dust Pouch

1. Open Capsule X by pressing latch A and opening the cover B. Always remove the Extension Tube and any accessories first.
 2. Simply drop the Dust Pouch into the cavity, with the circular card outermost.
 3. Check alignment and that the Dust Pouch card is sitting flat. Reclose.
- IF the cover does not close easily check Dust Pouch alignment.
Do not force closed.

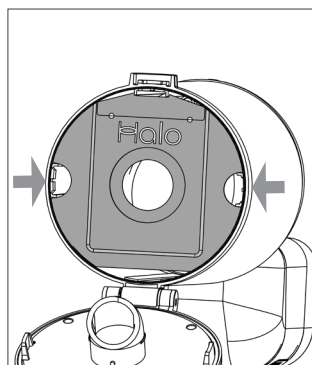
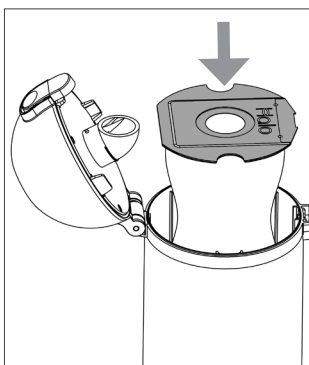
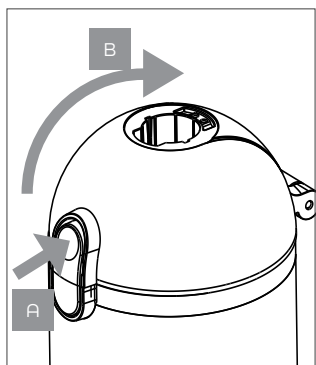

Fitting the Battery

4. Swing closed the cover B, if necessary pushing the latch at position C until an audible click is heard.
 1. Align Battery with rear of the Capsule X Main Unit, with the Halo logo upright.
 2. Push the Battery into place until a audible click is heard.
- Check Battery is secure both at the top and bottom before use.

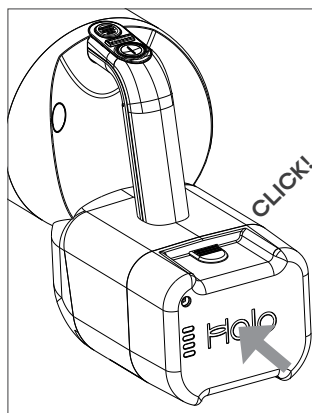
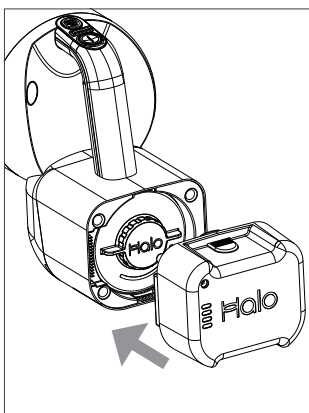
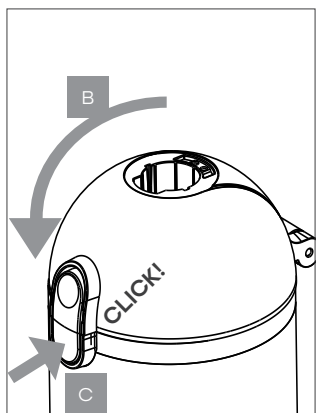

Charging

The charger connects between the Capsule X Battery and the mains.

The Battery can be charged while it is connected to Capsule X or when separated.

The Battery can not be charged when Capsule X is in use.

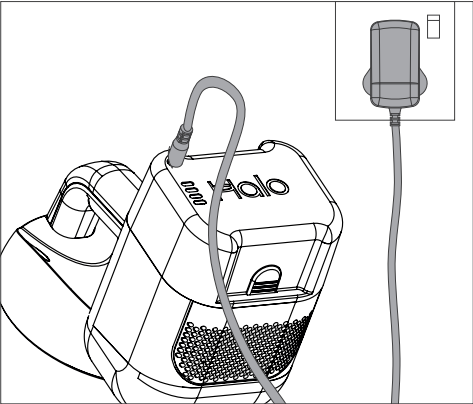

Runtime indicator

The Battery indicator will show fewer bars lit as Capsule X is used.

The last bar will flash red shortly before the Battery is exhausted.

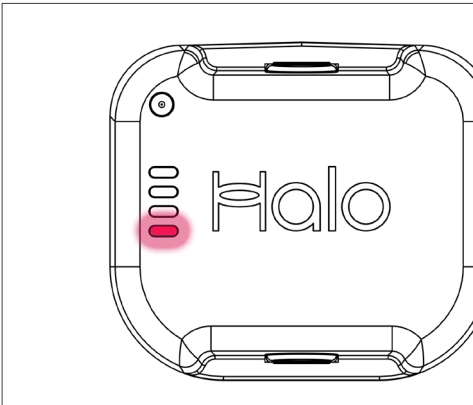

Charging Status

Whilst charging, the Battery indicator will show the level of charge from 0-100% in 25% increments.

Capsule X can be left connected when fully charged. The charger will enter sleep mode and no electricity will be consumed.

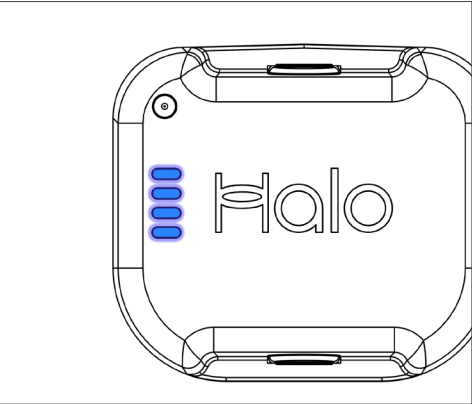

Runtime hints and tips

For full runtime Capsule X should be charged for 2 hours from empty and cool. Allow an extra 30 mins if the battery is very warm.

Capsule X's onboard computer estimates charge level and may show Full prior to this time. Charge for the full 2.5 hours.

Runtime Guide

Eco Mode	Over 60 minutes
Performance Mode	Over 25 minutes
Boost	Approx 9 minutes

Figures are estimates based on in home testing. Results in different homes may vary with different ambient temperatures and flooring types.

Additional batteries to provide extra runtime are available from Halo.

Attaching the accessories

The accessories can be attached in a variety of ways

1. The Motor Brush Head or any of the accessories can be attached to the end of the Extension Tube.
2. Alternatively any of the accessories can be connected directly into the Capsule X Main Unit to allow handheld operation.

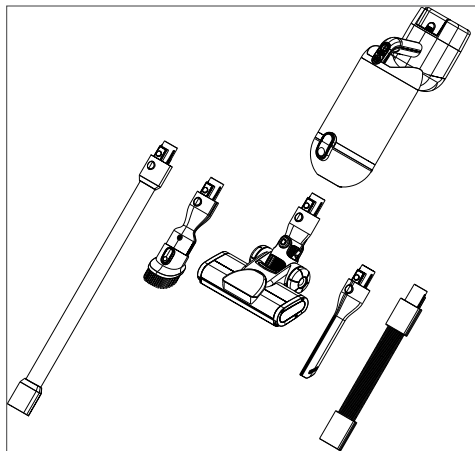
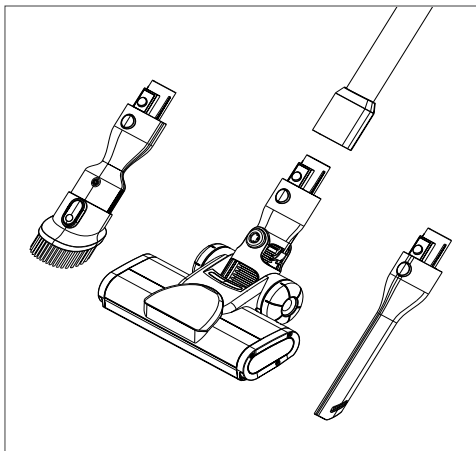

3. Release accessories by depressing the release button (A) then pulling them away from the Main Unit (B).

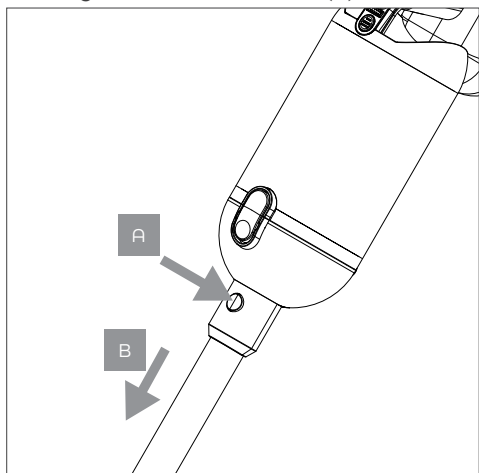

Accessory Clip

4. The accessory clip can be fitted to the top of the Extension Tube. Simply push the clip onto the tube then insert the chosen accessory. This can then be carried with your Capsule X.

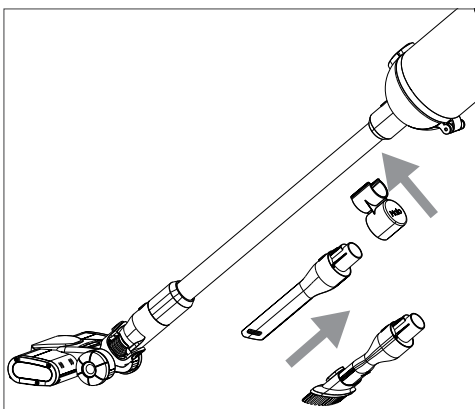

Reclining to Clean

Simply recline Capsule X while keeping one foot on the Motor Brush Head. There will be an audible click. This is normal.

Capsule X is ready to Clean

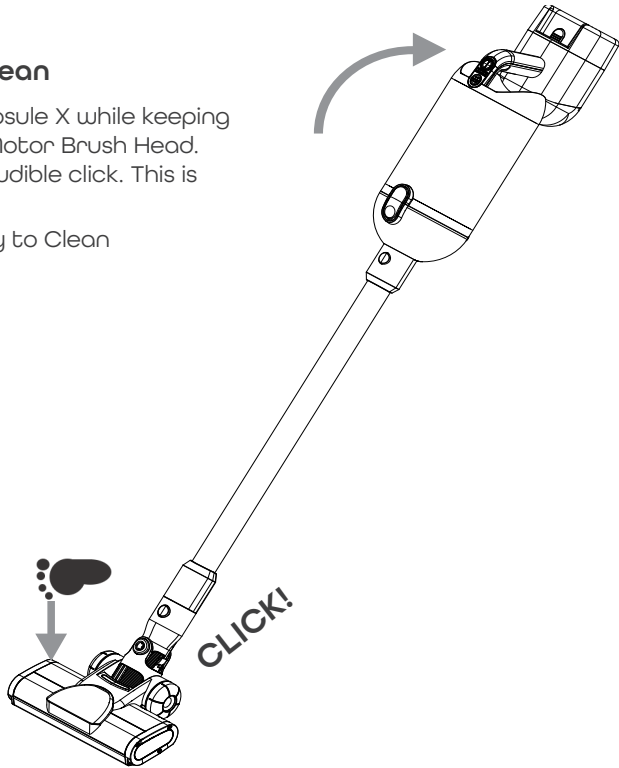

Powering up

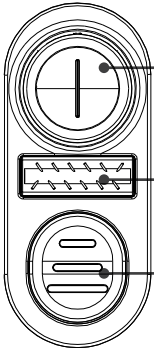

- 1 Main on/off**
Starts Capsule X.
Capsule X always starts in Performance mode.
 - 2 Motor Brush Head on/off**
Starts the Motor Brush Head or Hard Floor Roller if fitted
For best results on carpets and rugs it is recommended to have the brush rotating when cleaning.
 - 3 Power Volume Button**
Press to cycle between Eco, Performance and Boost mode.
- | | | |
|---|---|--|
| ≡ Eco
For longest runtime and great cleaning. | ≡ Performance
For powerful cleaning on carpet and hardfloor | ≡ Boost
Available For short periods where maximum performance is required. |
|---|---|--|

Motor Brush Head

Press the Motor Brush button to start the brushes turning. A green light will appear while in operation.

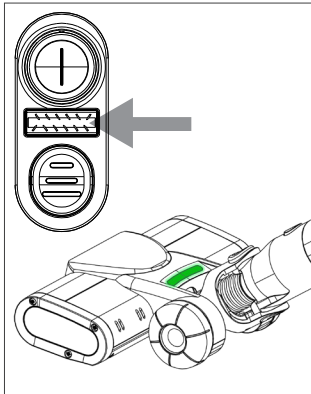

Brush usage

The Motor Brush Head can be used for cleaning carpets and rugs. The brush should be switched off for hard floor surfaces.*

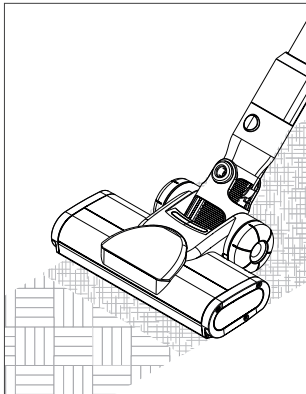

Cleaning Stairs

For stability and convenience the Motor Brush Head or Mini Power Brush can be connected directly to the Capsule X main unit.

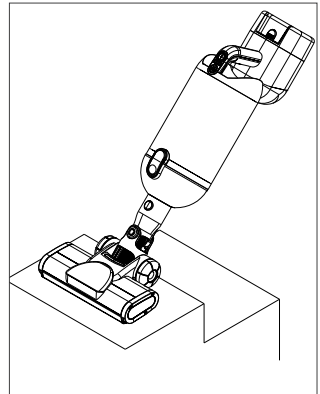

***Note:** For the very best cleaning performance on Hard Floor Halo recommend using the available Hard Floor Roller.

Removing the Battery

1. Press top and bottom Battery release buttons (A and B) together.
2. Withdraw Battery From Capsule X main unit.

The Battery can be charged whilst removed.

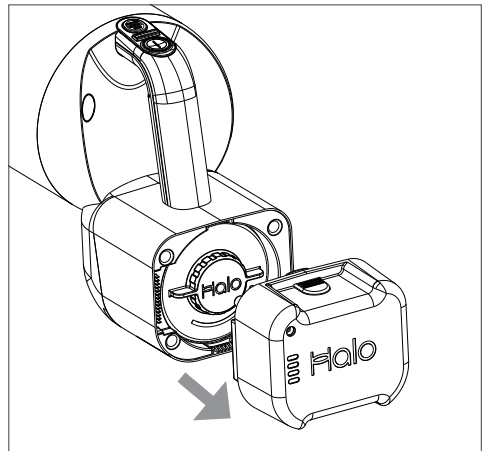
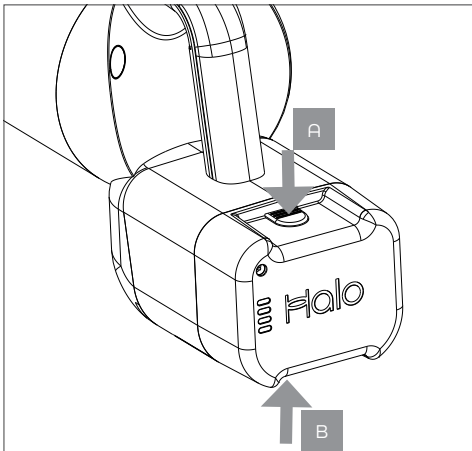

Holding and Carrying

Capsule X Equilibrium Engineering

Halo Capsule X is designed to be perfectly balanced in use for easier handling and the feeling of ultimate lightweight.

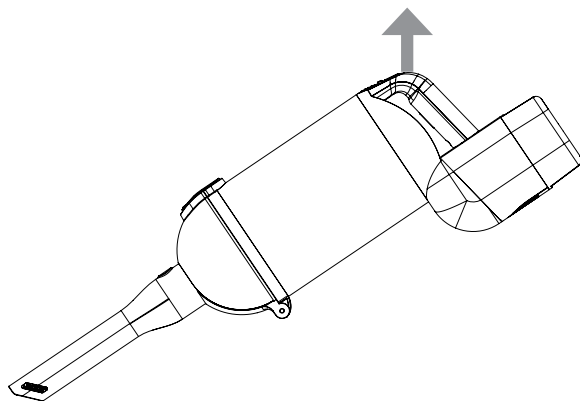

For convenience when moving Capsule X it can be carried by the main handle.

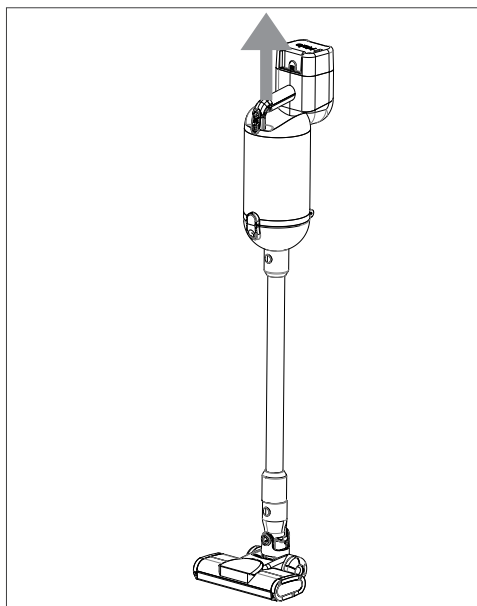

Carry the Capsule X up stairs by holding it on the Extension Tube just below the Main Unit. This leaves the other hand free to hold the handrail.

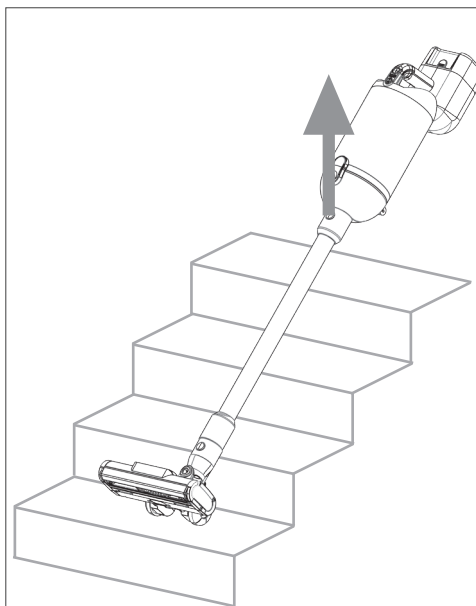

Changing the Dust Pouch

Dust Pouch indicator

When the Dust Pouch is Full and Capsule X is running in Boost mode the indicator will constantly light red.

To maximise dirt capacity Halo recommend occasionally gently shaking the Capsule X Main Unit between uses to evenly distribute the dirt in the dust pouch.

Use Boost mode periodically to check the indicator. The light is an indicator only and Halo recommend intermittent visual checks inside the dust pouch.

1. Remove the Extension Tube and any accessories.

Open Capsule X by pressing the latch A, then swinging open the cover B.

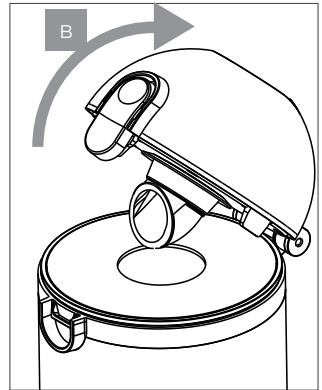
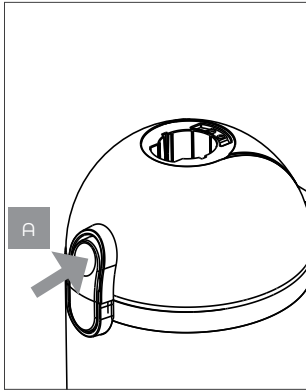
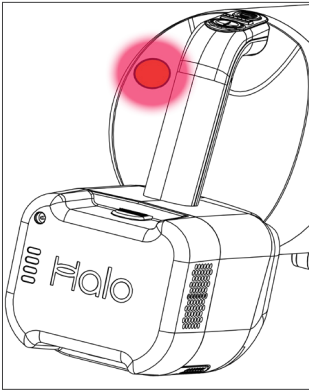

2. Lift the Dust Pouch clear or let it drop under its own weight. Always dispose of Dust Pouches responsibly.

3. Simply drop the new Dust Pouch into the cavity, with the circular card outermost. .

4. Check alignment and that the Dust Pouch card is sitting flat. Reclose.

If the cover does not close easily check Dust Pouch alignment.

Do not Force closed.

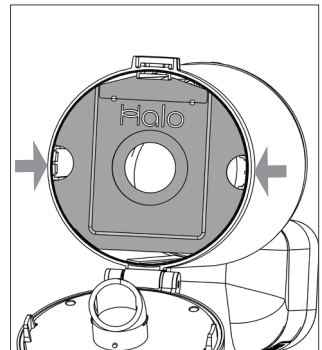
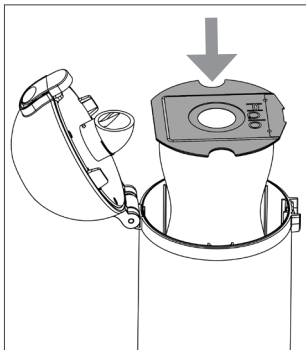
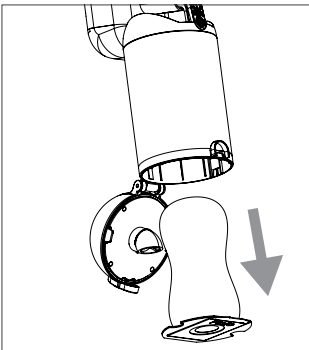

Maintenance

Capsule X is designed to be as free from maintenance as possible, but the following can help keep your Capsule X in top condition.

Blockages

All vacuums block from time to time. With Capsule X most blockages can be fixed by simply changing the Dust Pouch and using Boost mode to suck through any blockages.

In the event this is unsuccessful check the Extension Tube and Motor Brush Head for remaining blockages and remove these by hand. The use of sharp tools may damage Capsule X and invalidate the warranty.

Motor Brush Head

Periodically, hair can become wrapped around the brush roll and should be removed to maintain peak performance.

1. Remove the Motor Brush Head from both the Capsule X unit and the Extension Tube in order to isolate it from any power source.
2. Unlock the endcap (A) by turning it anticlockwise.
3. Turn until the brush can be withdrawn
4. The brush roll can then be completely removed.
5. Hair can be trimmed clear with a pair of scissors.
6. Ensure all parts are clear of hair and obstructions. Parts should reassemble without being forced.
7. Reinsert brush roll and turn endcap clockwise to secure.

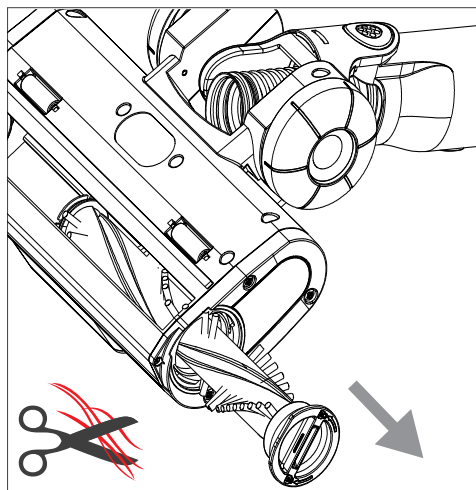
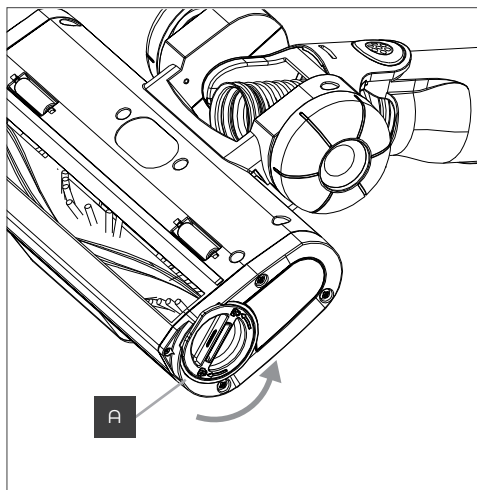

Dust Pouch Filter

After sustained periods of heavy use or if the Dust Pouch has become damaged then the Dust Pouch Filter may need to be cleaned or replaced.

Once the Dust Pouch has been removed the filter can be pulled out of the pouch chamber using the tab shown.

The Filter can be rinsed thoroughly under a tap and then dried for 24 hours before being replaced.

Use of a wet filter will invalidate the warranty. Never use Capsule X without the Filter fitted.

Always ensure tab is positioned outward when replacing the Filter.

Once refitted check the Filter is secure, fitted all the way around its diameter and that it does not drop out under its own weight.

Halo recommend cleaning or replacing the Dust Pouch Filter every 6-12 months.

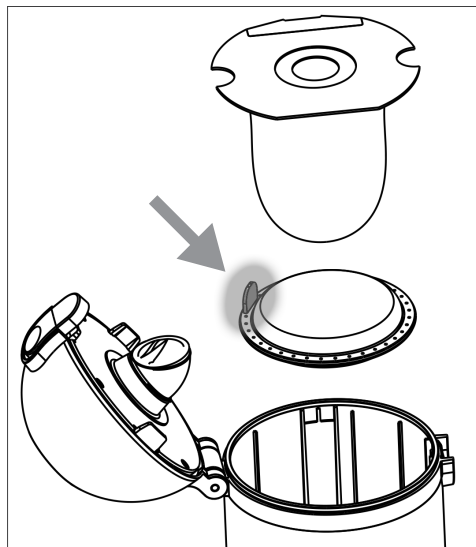

Exhaust Filter

After sustained periods of heavy use or if the Dust Pouch and/or Dust Pouch Filter have become damaged then the Exhaust Filter may need to be replaced. The filter is not washable and should be replaced completely at the end of its life.

Halo recommend replacement of the exhaust filter every 2 years.

If required replacement Filters can be purchased from capsuleclean.com/spares

1. Remove the Battery (see page 10) and turn the filter anticlockwise to unlock.

2. Pull the filter clear.

To refit turn clockwise until horizontal.

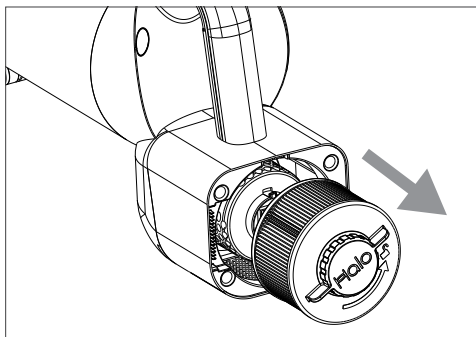
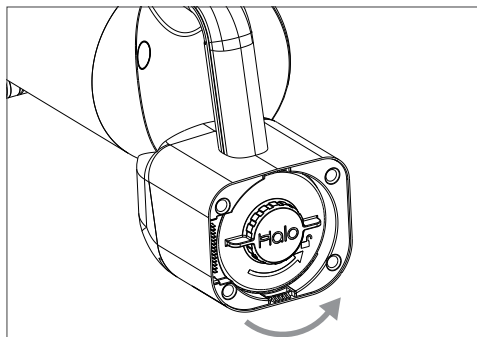

Hard Floor Roller

Should items become trapped around the roller the roller can be removed.

1. Depress the button (A) then rotate the end cap clockwise (B).
2. The roller can then be withdrawn.

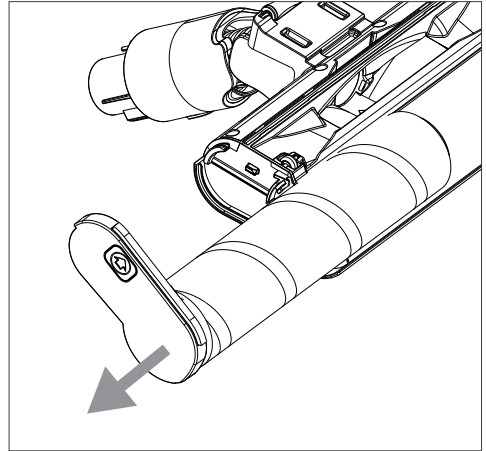
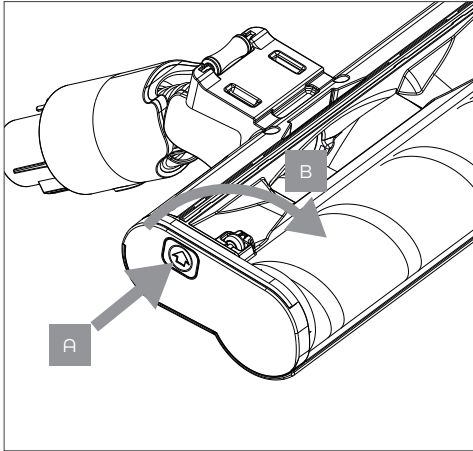

Mini Power Brush

To maintain peak performance periodically remove hair from the brush.

1. Use a small coin or screwdriver to unlock the fastener anticlockwise (A) rotate the end cap anticlockwise (B).
2. The mini brush can then be withdrawn. Hair can be trimmed clear with a pair of scissors.

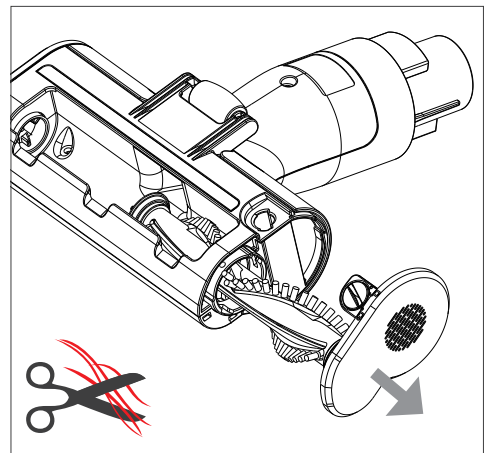
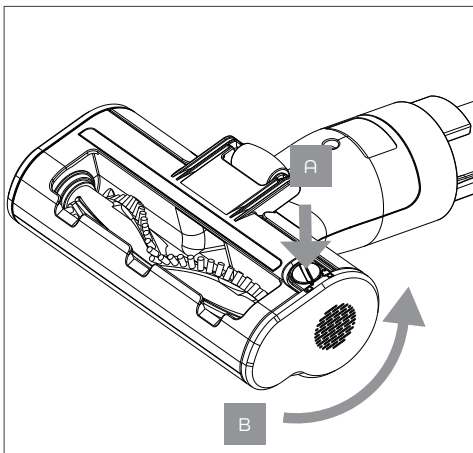

Troubleshooting

Capsule is not cleaning well	<ol style="list-style-type: none">1. Change the Dust Pouch.2. Check For blockages.3. Remove hair From the Motor Brush Head.
Capsule won't switch on	<ol style="list-style-type: none">1. Charge the Battery For at least 2.5 hours2. Change the Dust Pouch and check For blockages.3. Let Capsule X cool For 30 minutes and try again.
Dirt is Falling back out of the Motor Brush head	<ol style="list-style-type: none">1. Change the Dust Pouch2. Check For blockages
Motor Brush Head light turns red/ orange	<ol style="list-style-type: none">1. Remove the brushes. ensure there is nothing tangled around them.2. Inspect the floor tool case and piping for any blockages or damage.3. Power up the floor tool without the brushes inserted and check for Function.4. Reinsert the brushes, ensuring they click back in Fully.
Battery not lasting	<ol style="list-style-type: none">1. Leave the charger connected for at least 2.5 hours2. Check the correct Halo charger is being used.

If the above does not work please email our UK based contact centre hello@capsuleclean.co.uk where we will be happy to help.

Capsule technical specification

Voltage	32V
Battery capacity	57.6Wh
Charge time	2 hrs (cool battery) 2.5hrs (hot battery)
Charger	34.2V DC 1A
Weight	2.6Kg

Indicator lights

In the event of a problem Capsule X has a handful of helpful feedback lights.

Red light on Motor Brush Head

Brush is jammed

1. Disconnect the Motor Brush Head from the Extension Tube and main body to isolate it from power.
2. Check for blockages.

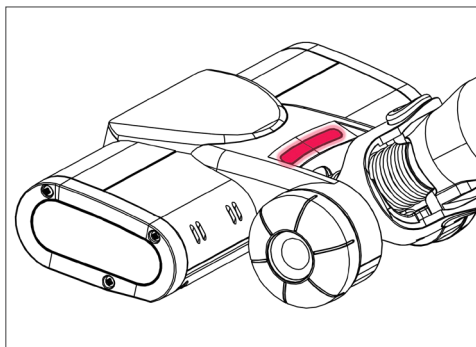

2 lights flashing on Battery

Battery is hot

1. Battery will not function until cool.
2. Cooling will take approximately 30 minutes at room temperature.
3. Normal function will then resume.

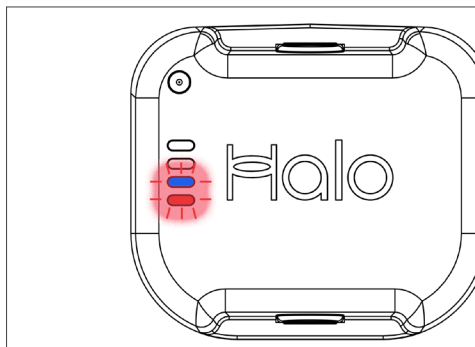

Dust Pouch indicator Flashing

Capsule X main unit is hot!

Stop using Capsule X.

2. Check for blockages.
3. Change the Dust Pouch and charge the Battery.
4. Allow Capsule X to cool for at least 30 minutes.

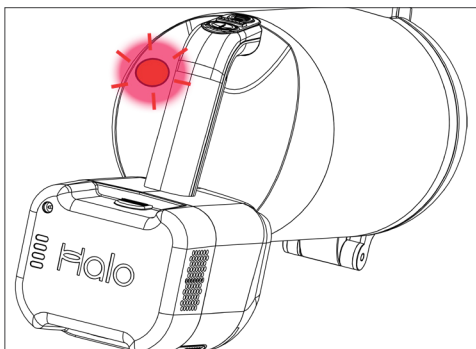

4 lights flashing on Battery

Battery removed whilst in use OR Capsule X motor is jammed

1. Remove then reattach the Battery.
2. Check filter and Dust Pouch are in place.
3. Fully charge the Battery.
4. If problem persists contact Halo support hello@capsuleclean.co.uk

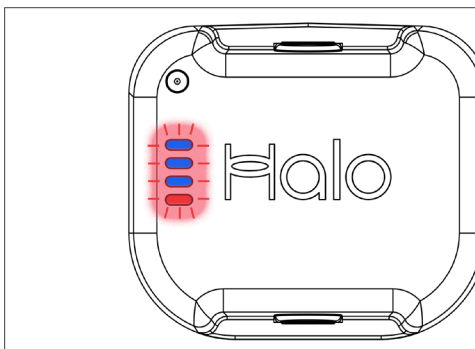

Warranty registration

Your new Capsule X comes with a complementary 2-year guarantee.

Your proof of purchase acts as your registration document, please have this to hand if you ever need to contact Halo.

What's covered

- If Capsule is used in the way it is intended and breaks down whilst being used for normal domestic cleaning within the guarantee period it's our responsibility to repair or replace it.

What's excluded

- Normal wear and tear of consumable items, for example belts, filters, Dust Pouches, Motor Brush Head etc.
- Batteries or rechargeable batteries which have become faulty or have a reduced life as a result of normal wear or improper handling.
- Accidental damage as a result of:
 - Use not in accordance with the user guide.
 - Not carrying out regular maintenance.
 - Damage to cable.
 - Blockages caused by misuse.
 - Accidental Damage
- Faults caused by:
 - Negligent use, misuse, neglect or careless operation of Capsule X not in accordance with the user guide.
 - Use of Capsule X for anything other than normal domestic purposes in the country it was purchased.
 - Use of parts, accessories and consumables which are not genuine Halo components.
 - Faulty installation or repairs unless carried out by a qualified electrician or engineer.

For full warranty terms and conditions see capsuleclean.com/warranty

Installing the Wall Dock

1. The Wall Dock should be mounted using the fixings provided.

The Dock should be 100-105cm above the floor.

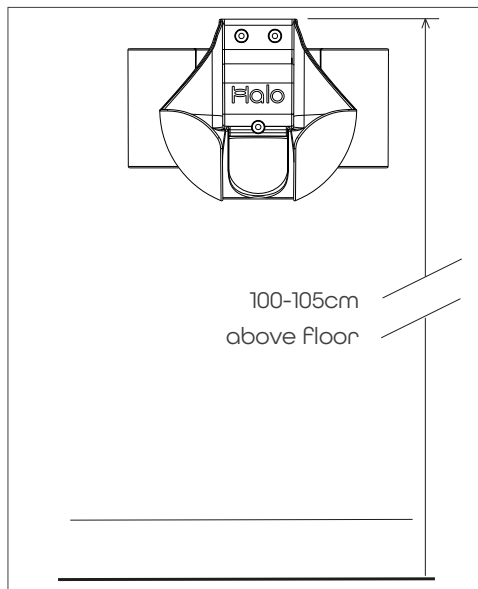

2. For convenience the charging cable can be attached for easy connection. The cable should be pushed into the grip features to secure.

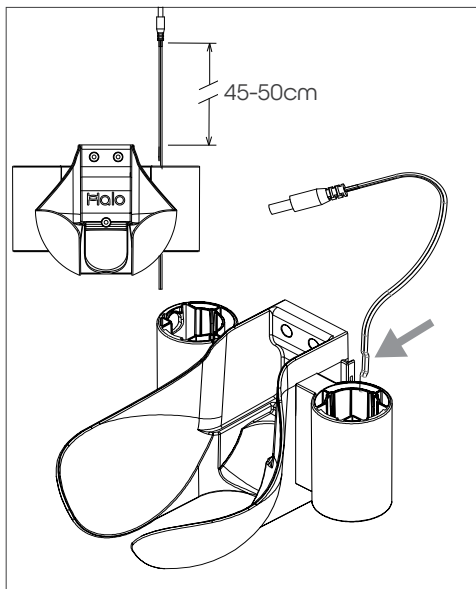

3. The Capsule X Vacuum and up to 4 accessories can then be held by the Wall Dock.

Ensure the Wall Dock is secure to the wall before use. Periodically check it has not become loose over time.

Capsule X **MUST** have the Extension Tube connected in order to be secure in the Wall Dock.

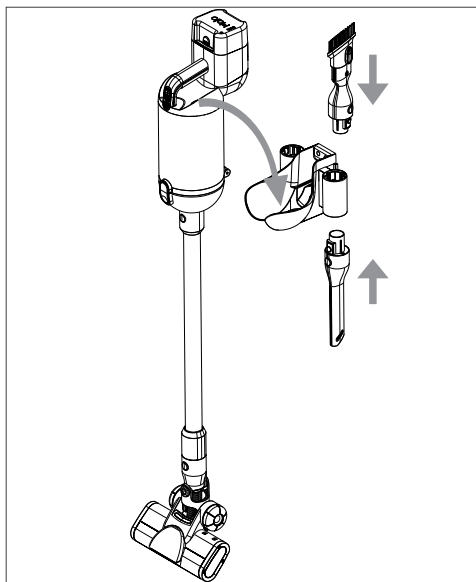



Halo Appliances Ltd.
Warwickshire, England

capsuleclean.com/contact